

Getriebe - F23

F23 Variante 1

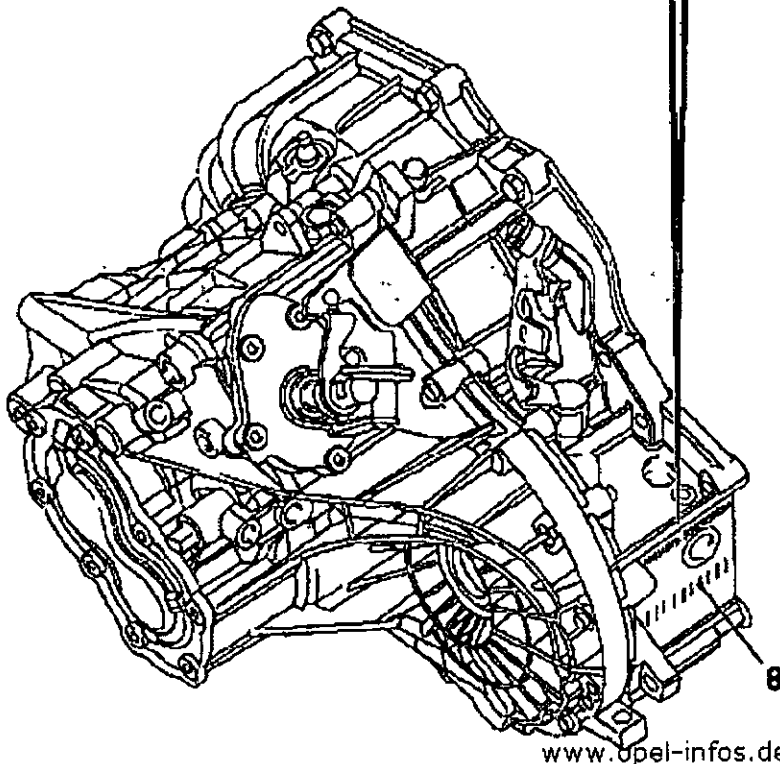
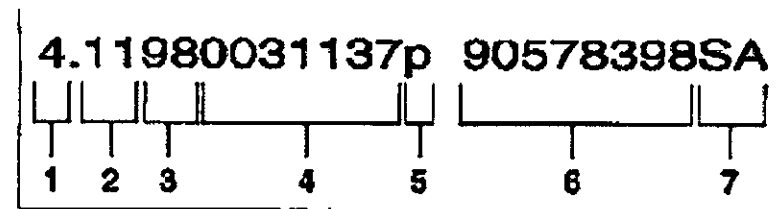

www.opel-infos.de

Die Kennzeichnung ist in das Getriebegehäuse eingraviert.

1 = Gehäusotyp

- 1 = J-Car Fam. 2
- 2 = J-Car V6
- 3 = J-Car L850
- 4 = T-Car Fam. 2.
- 5 = T-Car L850

2 = Getriebe-Code Radsatz und Abtriebsübersetzung

1. Ziffer Radsatz:

- 0 = SR (Short ratio)
- 1 = WR (Wide ratio)
- 4 = SRT (Short ratio Turbo)

2. Ziffer Abtriebsübersetzung:

- 0 = 3,74
- 1 = 3,84
- 2 = 3,95
- 3 = 4,17
- 4 = 3,63

3 = Jahresendzahl

4 = Seriennummer

- 5 = Getrag interner Änderungsindex
- 6 = Opel/Vauxhall-Teilenummer
- 7 = Alphacode
- 8 = Barcodeaufkleber

F23 Variante 2

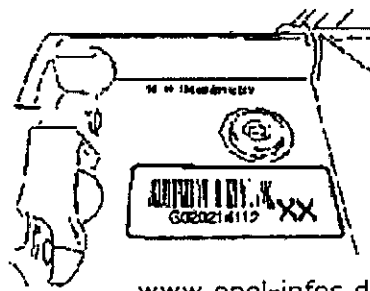
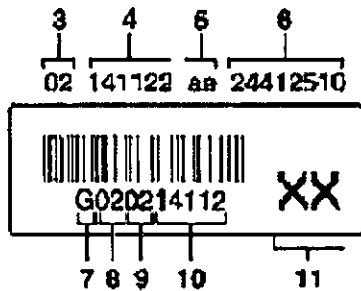
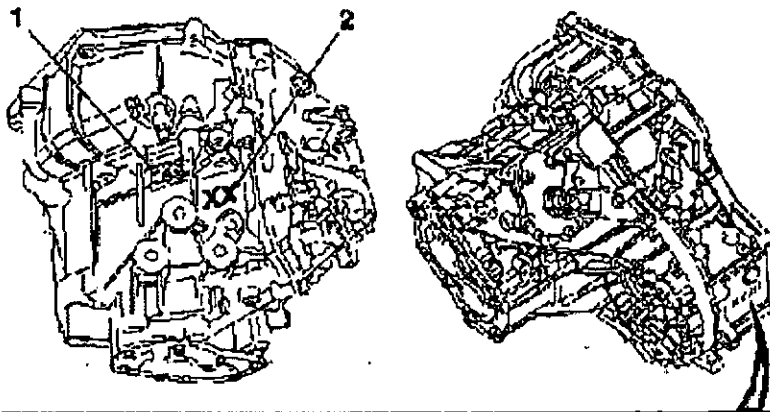

Der Getriebetyp ist an der Oberseite erhaben eingegossen. Der Alphacode ist an der Oberseite gestempelt.

- 1 = Getriebetyp
- 2 = Alphacode
- 3 = Jahresendzahl
- 4 = Seriennummer
- 5 = Getrag interner Änderungsindex
- 6 = Opel/Vauxhall-Teilenummer
- 7 = Herstellerwerk
- 8 = Radsatz
 - 01 = WR (Wide ratio)
 - 02 = SR (Short ratio)
- 9 = Jahresendzahl
- 10 = Seriennummer
- 11 = Alphacode

Gang	Übersetzung		
	F23WR	F23SR	F23SRT
1.	3,577	3,577	3,577
2.	1,887	2,022	2,022
3.	1,192	1,348	1,348

4.	0,848	0,977 ^S	0,977
5.	0,686	0,809	0,790
R	3,308	3,308	3,308
Kupplung	hydraulisch		
Schaltung	Seilzug		
Gewicht	ca. 42,8 kg		
Ölfüllmenge	ca. 1,75 Liter		
Getriebeöl	SAE 75W-85 API GL4		

S'ai pas écrit
Coulonay 4,17

Modell	Motor	Getriebeocode	Achsantrieb	Alphacode
Astra G	Z20LET	F23SRT	3,632 = 69/19	TR, AF
	Y20DTH	F23WR		SB, AG, AB
	X20XEV	F23SR	3,737 = 71/19	SH
	X20DTL	F23WR	3,842 = 73/19	SA
	X20XER	F23SR	3,947 = 75/19	TS
	X20XEV	F23SR		SC
	Z22SE	F23SR		SF, AH
Astra H	Z17DTH	F23WR	3,947 = 75/19	QJ
Corsa C	Z17DTH	F23WR	3,632 = 69/19	QF
Combo C	Z17DTH	F23WR	3,842 = 73/19	QG
Meriva A	Z17DTH	F23WR	3,842 = 73/19	QG
X Signum	Y20DTH	F23WR	3,737 = 71/19	XU
	Z22YH	F23SR	4,167 = 75/18	XY
Speedster	Z20LET	F23SRT	3,632 = 69/19	AF
	Z22SE	F23SR	3,947 = 75/19	TN
Vectra B	X20XEV	F23SR	3,737 = 71/19	SR
	X20DTH, Y20DTH	F23WR		SP
	X25XE, Y26SE	F23SR	3,842 = 73/19	SK
	X20DTH, X20DTL, Y20DTH	F23WR		SL
	X20XEV	F23SR	3,947 = 75/19	SS
	Z22SE	F23SR		ST
	X20DTL	F23WR		SM
	X20XEV	F23SR	4,167 = 75/18	SQ
Vectra C	Y20DTH	F23WR	3,737 = 71/19	XU
	Z22SE, Z22YH	F23SR	3,947 = 75/19	XX
	Z22YH	F23SR	4,167 = 75/18	XY
Zafira A	Z20LET	F23SRT	3,947 = 75/19	DZ
	Z22SE	F23SR	4,167 = 75/18	SG
	X20DTL, Y20DTH	F23WR		SJ, AK, AJ

Letzte Änderung: 13.05.2010

	IL	No de pièce	No de Cat.	Description	Usage	Portée	Qté	S
ENSEMBLE TRANSMISSION								
<input type="checkbox"/>		1	(90578397)	(7 00 051)	TRANSMISSION, ENS., RAPPORT3.95 (IDENT SC) (SAUF OPC) (UTILISER AUSSI 90470781 7 24 632) (PIECE D'ECHANGE 9201008 7 00 115 OPEL, R1510109 VAUXHALL) (NPD- UTILISER 9201008 7 00 115)	X20XEV[L34]	1	
<input type="checkbox"/>		2	(24426557)	(7 00 090)	TRANSMISSION, ENS., RAPPORT3.95 (IDENT TS) (POUR OPC) (UTILISER AUSSI 90470781 7 24 632) (PIECE D'ECHANGE 9200987 7 00 105 OPEL, R1510099 VAUXHALL) (PLUS DE MAINTENANCE - PAS DE PIECE DE RECHANGE)	X20XER[L34]	1	
<input type="checkbox"/>		3	(90578400)	(7 00 052)	TRANSMISSION, ENS., RAPPORT3.74 (IDENT SH) (UTILISER AUSSI 90470781 7 24 632) (PIECE D'ECHANGE 9201012 7 00 117 OPEL, R1510111 VAUXHALL) (PLUS DE MAINTENANCE - PAS DE PIECE DE RECHANGE)	X20XEV[L34]	1	
<input type="checkbox"/>		4	(9126007)	(7 00 088)	TRANSMISSION, ENS., 4.17, TAUX (IDENT SD) (POUR AFRIQUE DU SUD) (UTILISER AUSSI 90470781 7 24 632) (PLUS DE MAINTENANCE - PAS DE PIECE DE RECHANGE)	X20XEV[L34] 5 PORTIERE HAYON F48	1	
<input type="checkbox"/>		5	(90424091)	(7 00 091)	TRANSMISSION, ENS., 3.63, TAUX (IDENT TR) (NPD - UTILISER 24451449 7 00 220 ET FOURNIR 90470781 7 24 632) (PIECE D'ECHANGE 9200989 7 00 106 OPEL, R1510100 VAUXHALL)	Z20LET[L70] COUPE F07	1	
<input type="checkbox"/>		6	(24451449)	(7 00 220)	TRANSMISSION, ENS., 3.63, TAUX (IDENT AF) (PIECE D'ECHANGE 9200989 7 00 106 OPEL) (PLUS DE MAINTENANCE - PAS DE PIECE DE RECHANGE)	Z20LET[L70]	1	
<input type="checkbox"/>		7	(24461371)	(7 00 175)	TRANSMISSION, ENS., 3.95, TAUX (IDENT DZ) (NPD - UTILISER 24467329 7 00 227 ET FOURNIR 90470781 7 24 632)	Z20LET[L70] MONOCAB F75	1	
<input type="checkbox"/>		8	(90578402)	(7 00 053)	TRANSMISSION, ENS., RAPPORT3.95 (IDENT SF) (NPD - UTILISER 24451451 7 00 222 ET FOURNIR 90470781 7 24 632) (PIECE D'ECHANGE 9201014 7 00 118 OPEL, R1510112 VAUXHALL)	Z22SE[L61] HAYON, BERLINE, COUPE, BREAK, CAMIONNETTE F07, F08, F35, F48, F69, F70	1	
<input type="checkbox"/>		8	24451451	7 00 222	TRANSMISSION, ENS., RAPPORT3.95 (IDENT AH) (PIECE D'ECHANGE 9201014 7 00 118 OPEL)	Z22SE[L61] HAYON, BERLINE, COUPE, CABRIOLET, BREAK F07.	1	

				(RETOUR DE NOYAU NO 95 07 241)			
<input type="checkbox"/>		2	<u>9200987</u>	7 00 105	TRANSMISSION, ENS., RAPPORT3.95, ECHANGE (IDENT TS) (POUR OPC) (RETOUR DE NOYAU NO. 95 07 231)	X20XER[L34]	1
<input type="checkbox"/>		3	<u>(9201012)</u>	(7 00 117)	TRANSMISSION, ENS., RAPPORT3.74, ECHANGE (IDENT SH) (RETOUR DE NOYAU NO 95 07 242) (PLUS DE MAINTENANCE - PAS DE PIECE DE RECHANGE)	X20XEV[L34]	1
<input type="checkbox"/>		5	<u>9200989</u>	7 00 106	TRANSMISSION, ENS., RAPPORT3.63, ECHANGE (IDENTS TR & AF) (RETOUR DE NOYAU NO. 95 07 232)	Z20LET[L70]	1
<input type="checkbox"/>		8	<u>9201014</u>	7 00 118	TRANSMISSION, ENS., RAPPORT3.95, ECHANGE (IDENT SF) (RETOUR DE NOYAU NO 95 07 243)	Z22SE[L61] HAYON, BERLINE, COUPE, BREAK, CAMIONNETTE F07, F08, F35, F48, F69, F70	1
<input type="checkbox"/>		8	<u>9201014</u>	7 00 118	TRANSMISSION, ENS., RAPPORT3.95, ECHANGE (IDENT SF) (RETOUR DE NOYAU NO. 95 07 243)	Z22SE[L61] CABRIOLET F67	1
<input type="checkbox"/>		9	<u>9200985</u>	7 00 104	TRANSMISSION, ENS., RAPPORT4.17, ECHANGE (IDENT SG) (RETOUR DE NOYAU NO. 95 07 228)	Z22SE[L61] MONOCAB F75	1
<input type="checkbox"/>		10	<u>9200981</u>	7 00 102	TRANSMISSION, ENS., RAPPORT3.63, ECHANGE (IDENT SB) (RETOUR DE NOYAU NO. 95 07 228)	Y20DTH [LBS /LD1 /LP4] HAYON, BERLINE, BREAK, CAMIONNETTE F08, F35, F48, F69, F70	1
<input type="checkbox"/>		10	<u>93183216</u>	7 00 916	TRANSMISSION, ENS., RAPPORT3.61 (IDENT AB) (RETOUR DE NOYAU NO. 95 07 390) (POUR MOTEUR A HAUT RENDEMENT) (POUR NO. DE PRODUCTION 24451444 7 00 843)	Y20DTH [LBS /LD1 /LP4] HAYON, BERLINE, BREAK, CAMIONNETTE F08, F35, F48, F69, F70	1
<input type="checkbox"/>		11	<u>9201010</u>	7 00 116	TRANSMISSION, ENS., RAPPORT3.84, ECHANGE (IDENT SA) (RETOUR DE NOYAU NO. 95 07 194)	X20DTL[LD3] HAYON, BERLINE, BREAK, CAMIONNETTE F08, F35, F48, F69, F70	1
<input type="checkbox"/>		12	<u>9201016</u>	7 00 119	TRANSMISSION, ENS., RAPPORT4.17, ECHANGE (IDENT AK/SJ) (RETOUR DE NOYAU NO. 95 07 195)	X20DTL[LD3], (C) Y20DTH (C) [LBS /LD1 /LP4] MONOCAB F75	-22999999 -2H999999 1
<input type="checkbox"/>		13	<u>93183208</u>	7 00 915	TRANSMISSION, ENS., RAPPORT4.17 (IDENT AJ) (RETOUR DE NOYAU NO. 95 07 389) (POUR NO. DE PRODUCTION 24451452 7 00 369)	Y20DTH (C) [LBS /LD1 /LP4] MONOCAB F75 (C) 3H000001-	32000001- 3H000001- 1

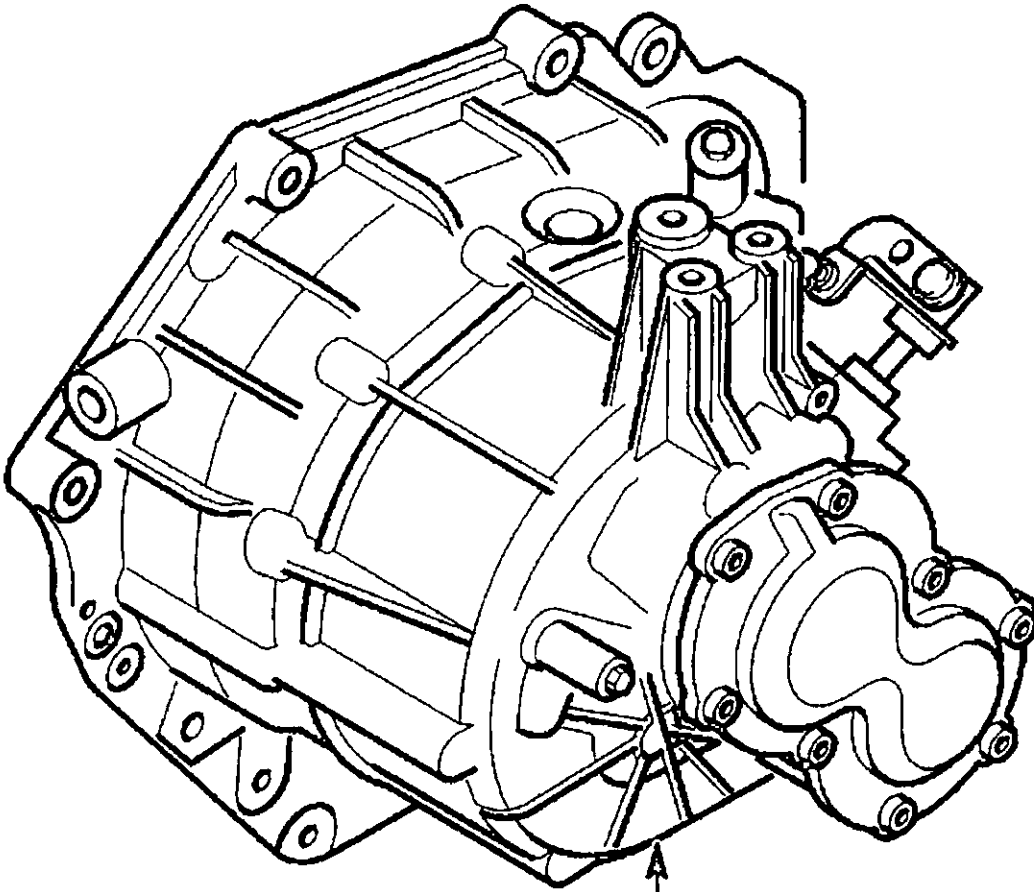

1	SC
2	TS
3	SH
4	SD
5	TR
6	AF
7	DZ
8	SF
9	SG
	SB
10	AG
	AB
11	SA
12	SJ
13	AJ

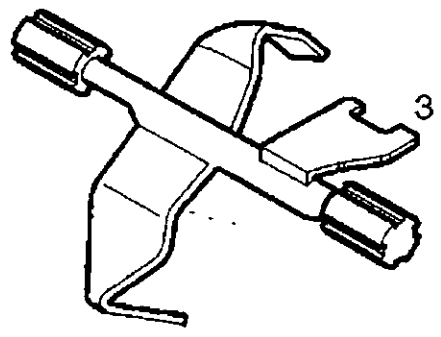
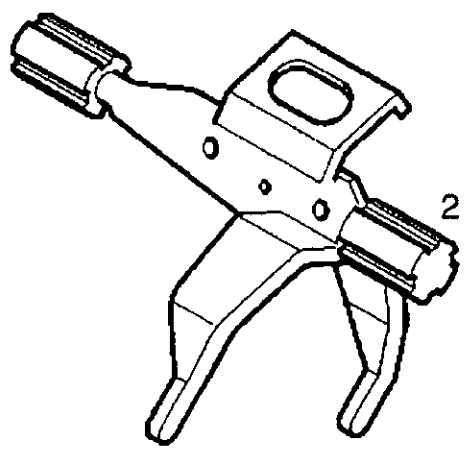
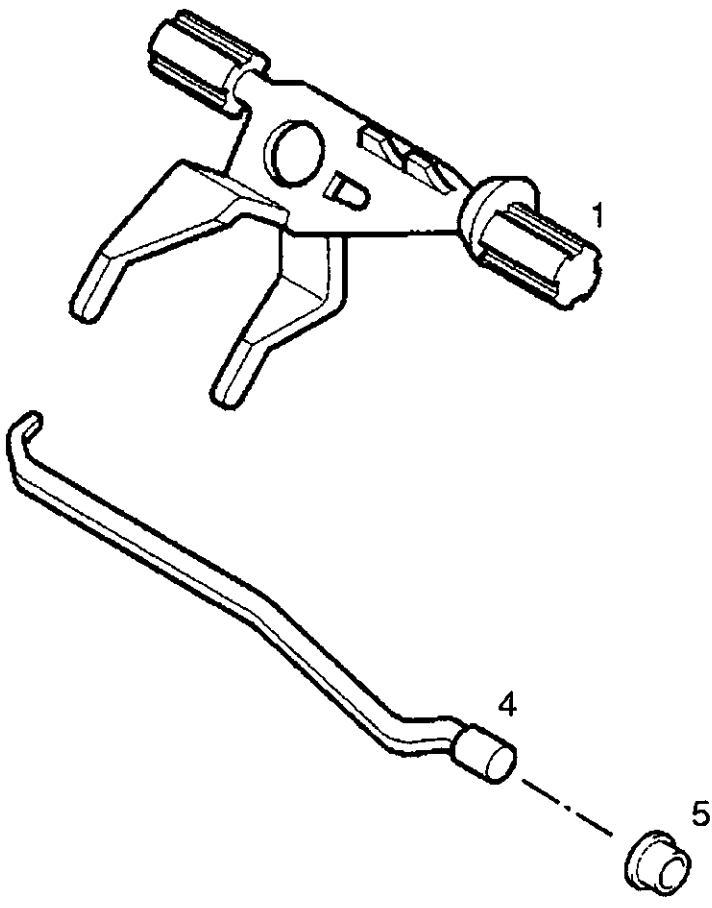

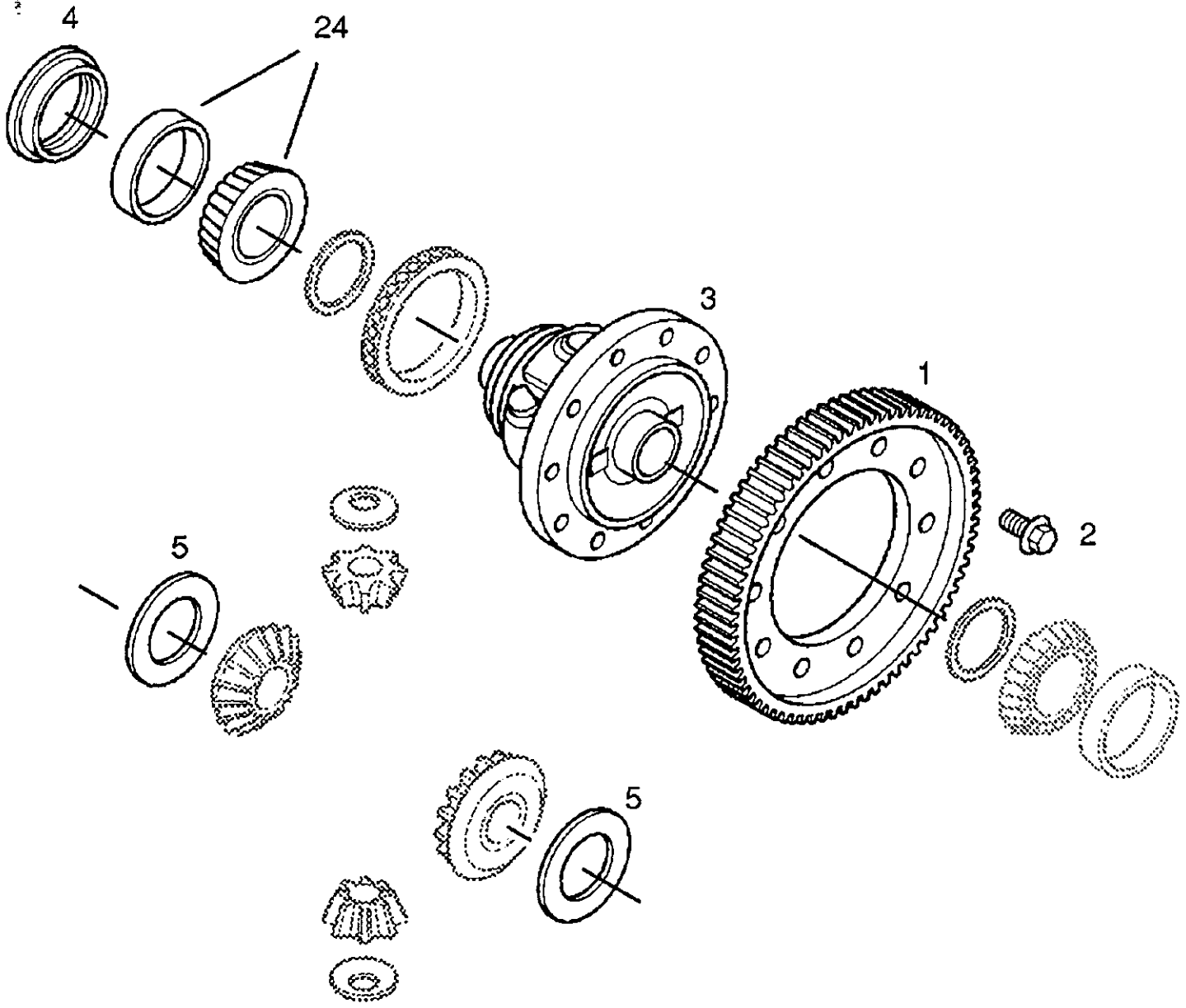

6	0.50MM	15	0.95MM
7	0.55MM	16	1.00MM
8	0.60MM	17	1.05MM
9	0.65MM	18	1.10MM
10	0.70MM	19	1.15MM
11	0.75MM	20	1.20MM
12	0.80MM	21	1.25MM
13	0.85MM	22	1.30MM
14	0.90MM	23	1.35MM

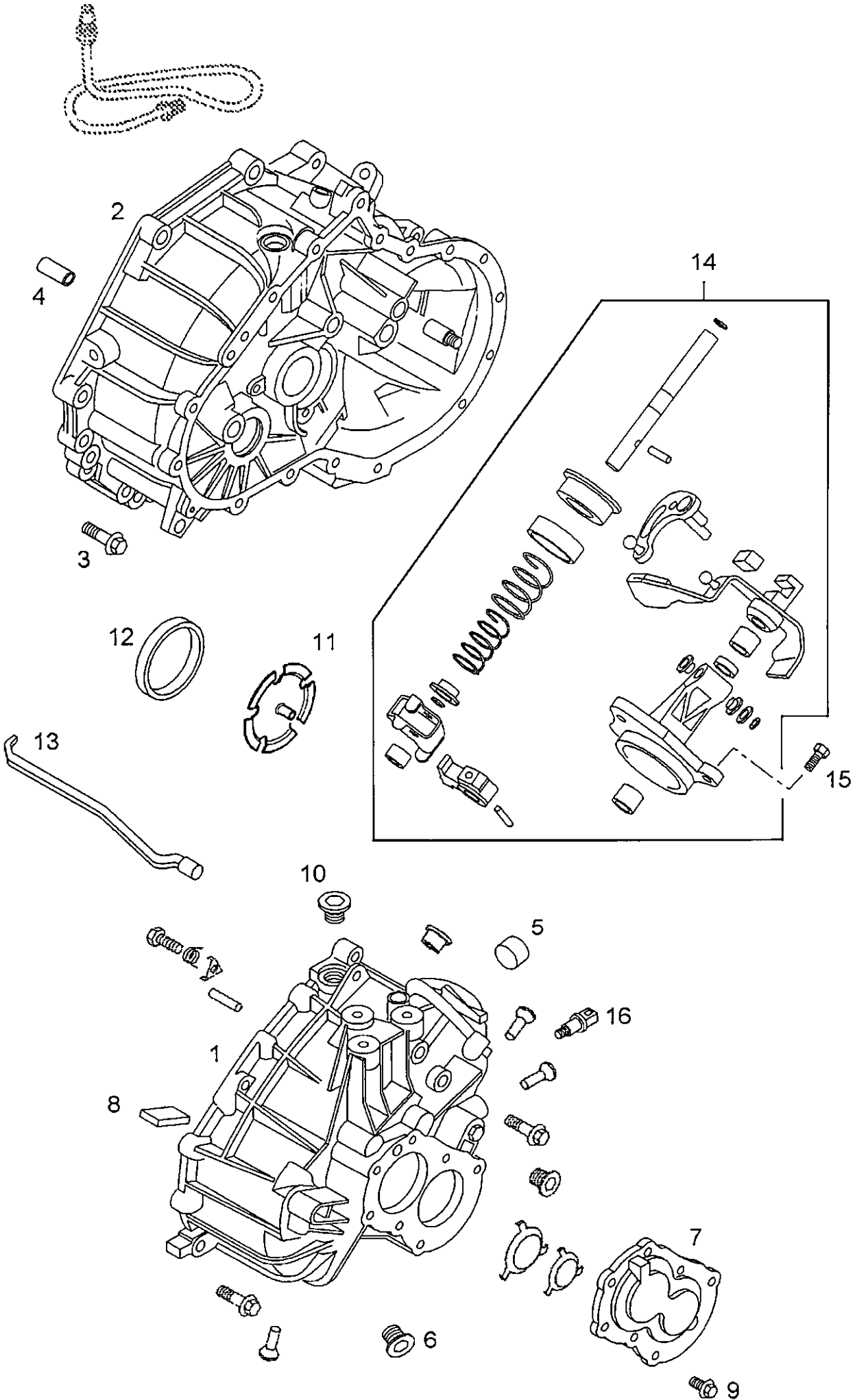

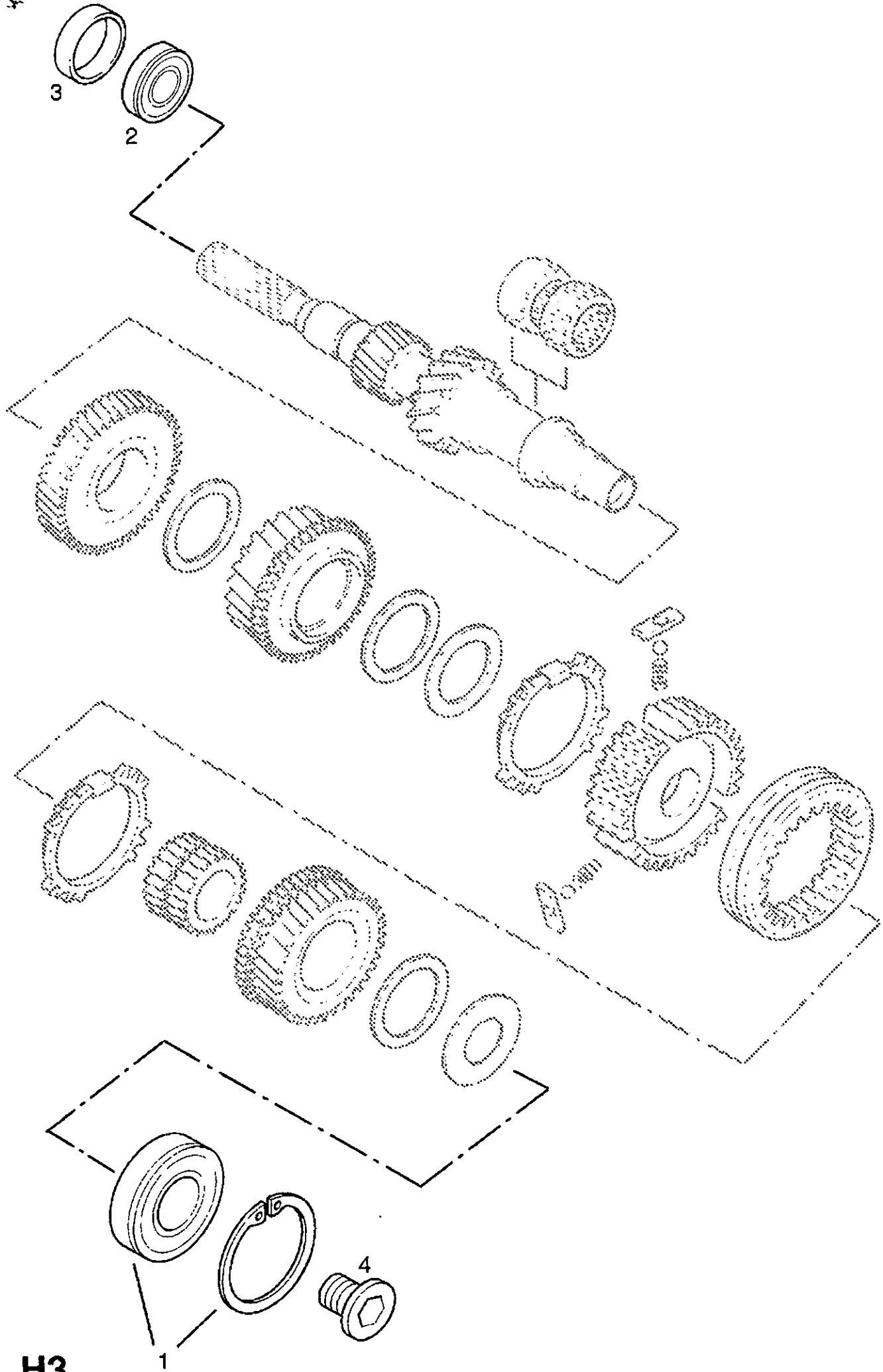

H3

57

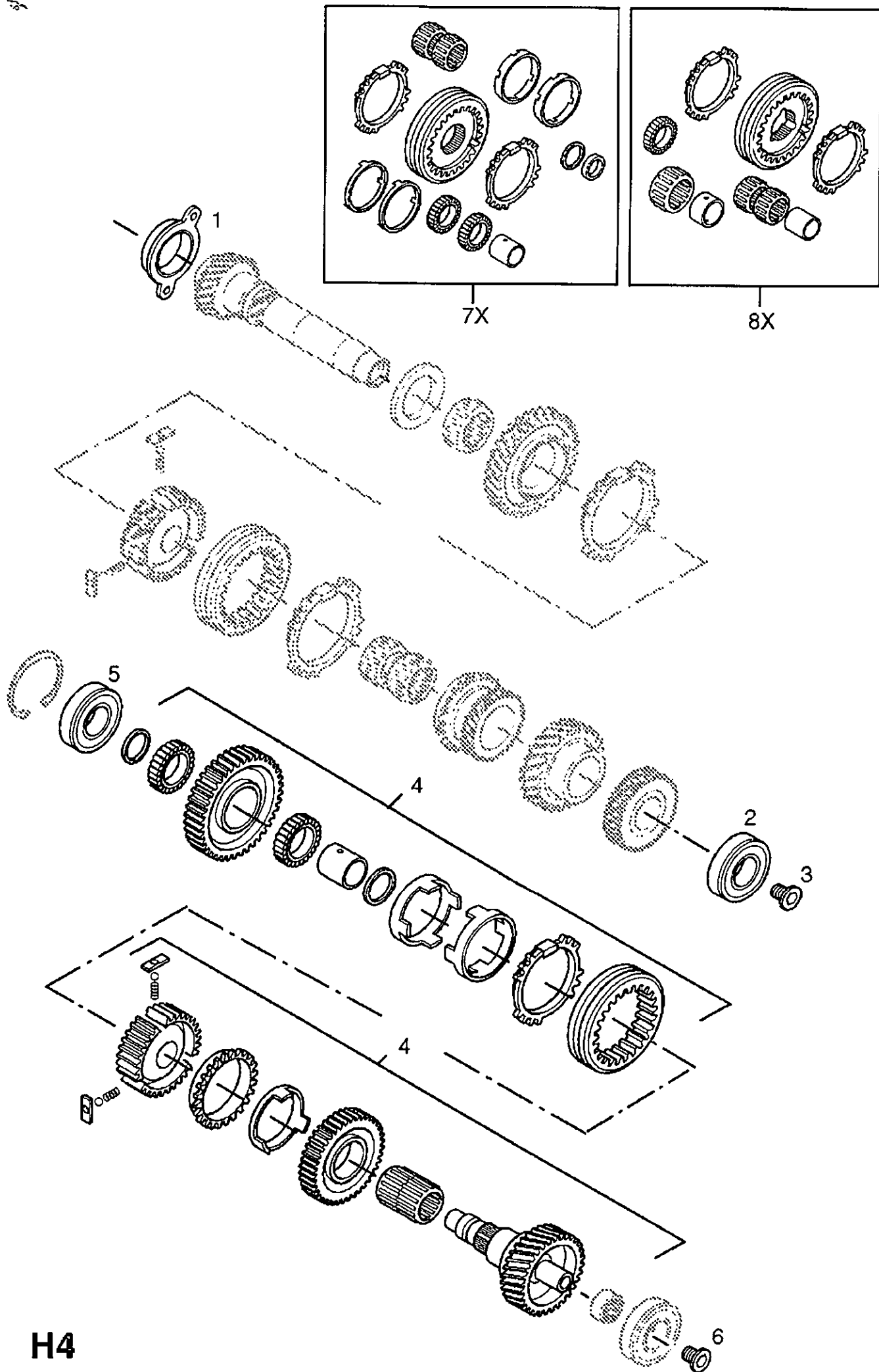

H4