

# CEILING DRILLING DIRECTIONS

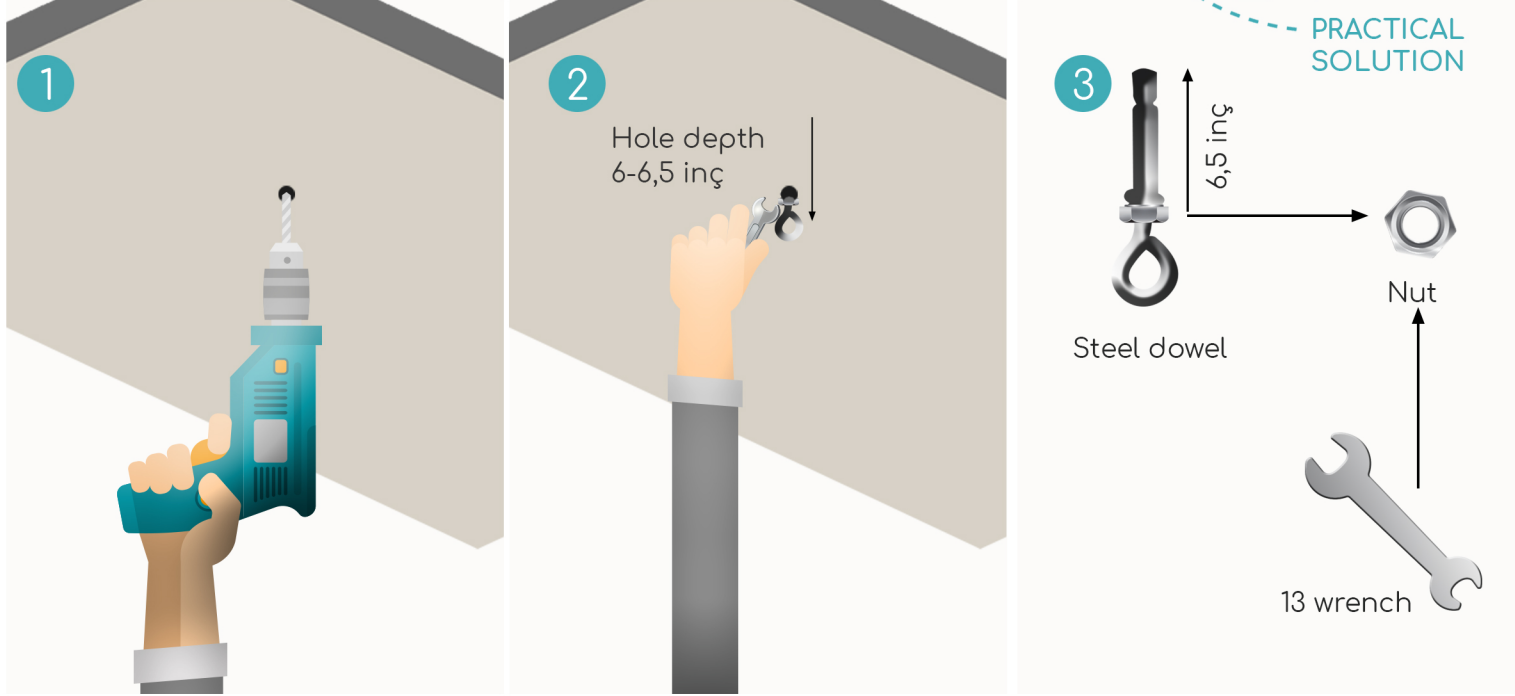

1- DRILL HOLES IN THE CONCRETE CEILING YOU WILL USE THE PRODUCT WITH A 10-PIECE DRILL.

2- THE DEPTH OF THE HOLE MUST BE 6.5 INÇ.

3- LIGHTLY DRIVE THE STEEL DOWEL INTO THE HOLE DRILLED IN THE CELLING AND TIGHETEN THE NUT UNDER THE ROUND HOOK WITH A 13 WRENCH.

WARNING: STEEL ANCHOR SUITABLE FOR CONCRETE CEILINGS. PLEASE DO NOT USE ON NON-CONCRETE CEILINGS.

AFTER INSTALLING THE STEEL DOWEL, PLEASE MAKE SURE IT IS INSTALLED INSTALLED AND TEST IN A CONTROLLED WAY BEFORE YOU LOAD YOUR BABY OR CHILD.