

FORMAT LED Aufbauleuchte 560

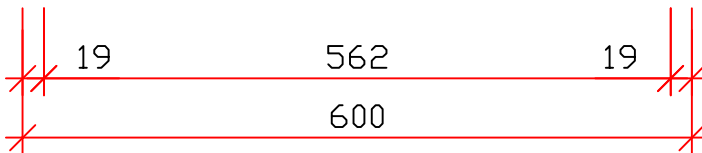
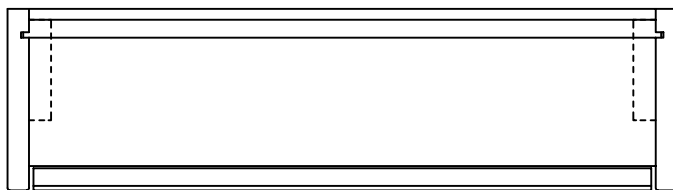
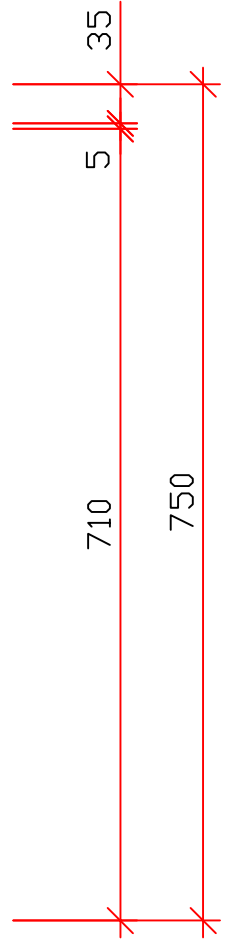
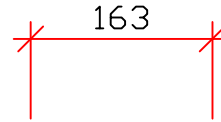
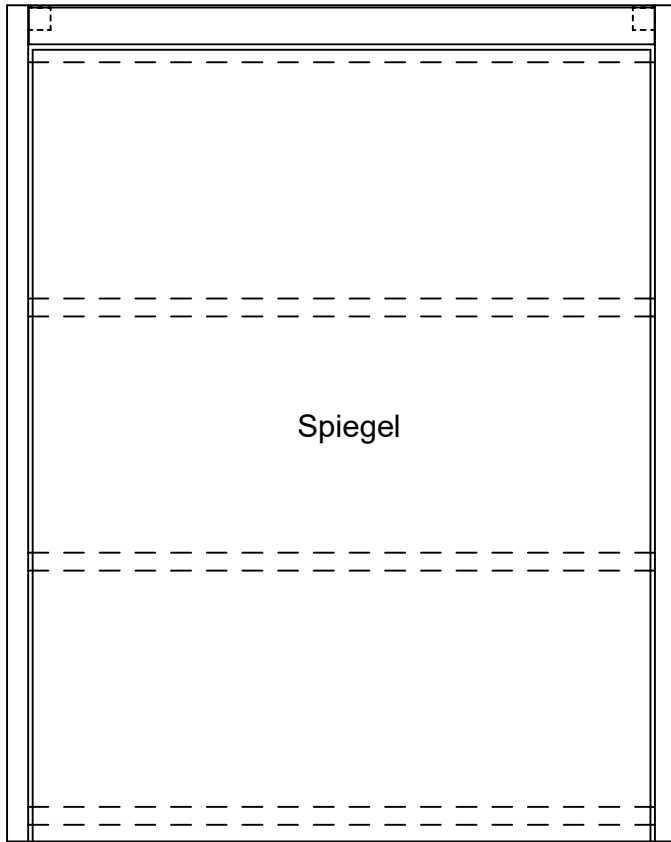

TRISPEND

Trispend AG
Sommerstrasse 37
CH-8580 Amriswil
Tel.: +41 (0)71 414 25 75
Fax: +41 (0)71 414 25 76
info@trispend.ch

Spiegelschrank Typ FN 600

Grösse: 600 x 163 x 750 mm (BxTxH)

Nr.
Datum: 22.09.20
Gez. AS