



Europahaus Mayrhofen

congress.zillertal



Forever our centrepiece

The plenary hall Europa has been the core of the building for over 40 years. We have carefully numbered, restored and reinstalled the detailed ceiling made of brushed pine while renovating in 2010. The hall is customizable according to the number of guests, or can be combined with the entire first floor to form one enormous space for your use. The technical unit is on the 2nd floor as well as a balcony with additional 67 seats in three rows.

Room Europa XS

Ground space	280 m ²
Length	11,5 m
Width	max. 24,8 m
Height	5,4-7,1 m
Max. theatre seating	300
Max. classroom seating	200

Room Europa

Ground space	429 m ²
Length	17,6 m
Width	13,2-24,8 m
Height	2,8-7,1 m
Max. theatre seating	500
Max. classroom seating	300

Room Europa XL

Ground space	641 m ²
Length	17,6 m
Width	ca. 30 m
Height	2,8-7,1 m
Max. theatre seating	720
Max. classroom seating	400

Main stage 8,1 x 11,9 m

Mobile stage 2,5 x 8,5 m

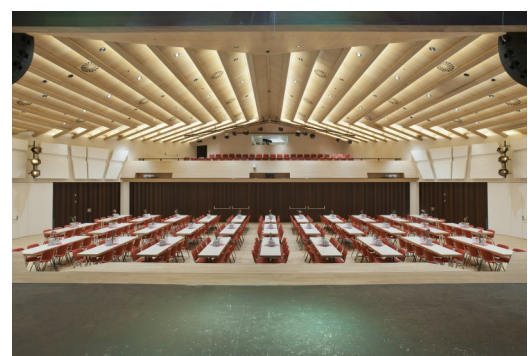
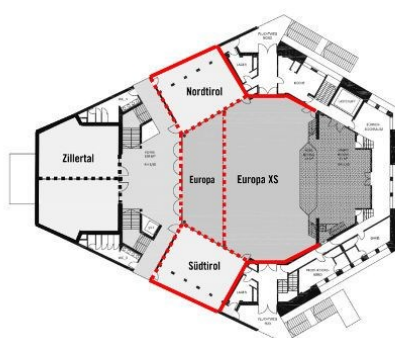



Made to measure

Room Zillertal on the first floor boasts a bottom to top glass wall. A new addition after the renovation in 2010, the room is tailored to our clients' needs. The room can be split up into two identical rooms (North & South) with 95,5 m² each and can both be connected to the foyer individually. The room is equipped with projector, screen, audio and AC.

Room Zillertal total

Ground space	195 m ²
Length	16 m
Width	11,9 m
Height	3,25 m
Max. theatre seating	230
Max. classroom seating	140

Rooms Zillertal North & South (each)

Ground space	97,5 m ²
Length	7,9 m
Width	11,9 m
Height	3,25 m
Max. theatre seating	100
Max. classroom seating	60

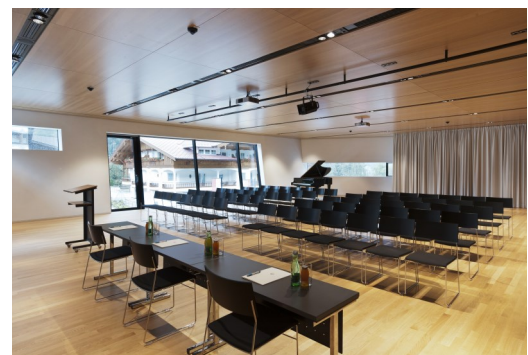



The best views of Zillertal

The twin rooms Südtirol and Nordtirol are situated just next to the main room Europa on the first floor and can be connected with the main room or the foyer individually. Both rooms are equipped with projector, screen, audio and AC - plus a lovely view of the Zillertal valley.

Room Südtirol

Ground space	106 m ²
Length	11,2 m
Width (to the columns)	6,9 m
Height	2,8 m
Max. theatre seating	70
Max. classroom seating	50

Room Nordtirol

Ground space	106 m ²
Length	11,2 m
Width (to the columns)	6,9 m
Height	2,8 m
Max. theatre seating	70
Max. classroom seating	50

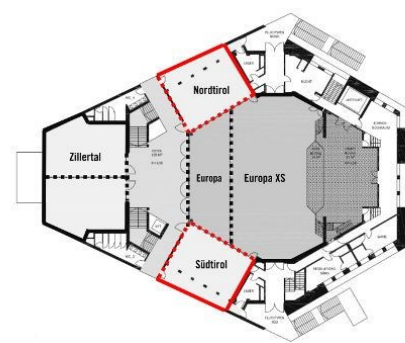



Europahaus Mayrhofen

congress.zillertal

MAYRHOFEN



Staying grounded

Room Mayrhofen on the ground floor is just next to the large exhibition area and can be connected to that space on request, for example for exhibitions or catering. The wall to the exhibition space may also be moved further into the room to create a cozy nook. The room is equipped with projector, screen, audio and AC.

Room Mayrhofen

Ground space	103 m ²
Length	14,1 m
Width	7,5 m
Height	2,4-2,9 m
Max. theatre seating	95
Max. classroom seating	60

Room Mayrhofen XS

Ground space	75 m ²
Length	10 m
Width	7,5 m
Height	2,4-2,9 m
Max. theatre seating	50
Max. classroom seating	30

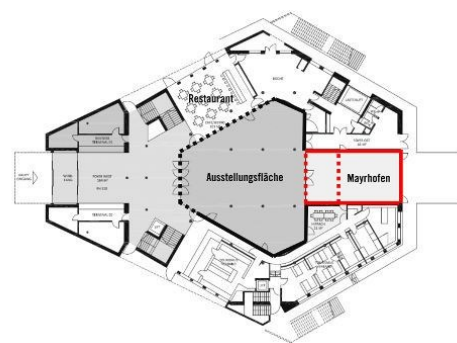



Europahaus Mayrhofen

congress.zillertal



Need more space?

The „Kellertheater“ in the basement is open for several options. This room without daylight may be used as breakout room, storage or office space but is also a unique concert or bar location. The large goods lift and delivery access is right on the other side of the room. Behind a curtain, there is an already installed bar ready at your service. The room can be combined with the foyer or split into three breakouts, each with a separate entrance.

Kellertheater

Ground space	200 m ²
Length	21,4 m
Width	7,5 m
Height	5,4-7,1 m
Max. theatre seating	300
Max. classroom seating	200

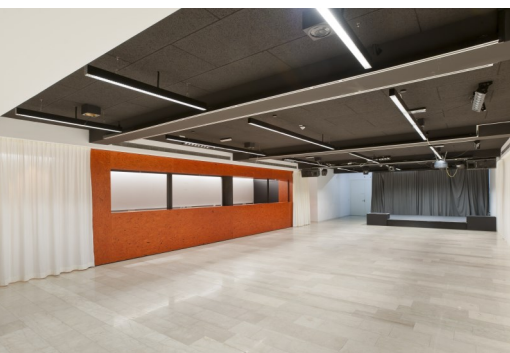
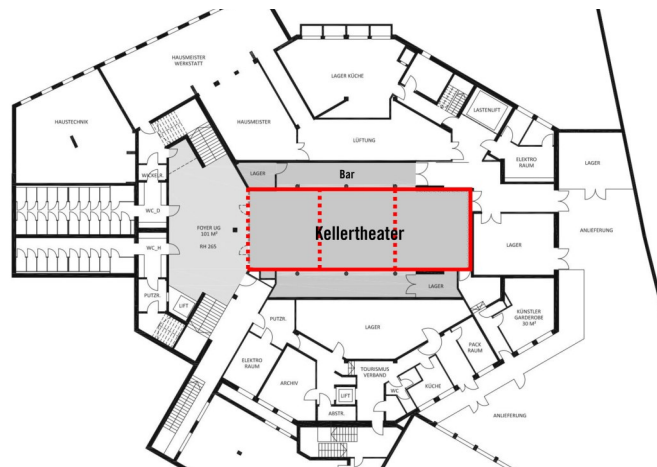



Europahaus Mayrhofen

congress.zillertal

EXHIBITION SPACE



Room to grow

The exhibition space on the ground floor is perfect for art displays, product presentations or combined with the restaurant as an interactive catering area. All walls on the ground floor can be opened for a space to meet, literally.

Exhibition space

Ground space	317 m ²
Length	18,5 m
Width	7,5-23 m
Height	3,6 m

