



D.B. TEC

COREL



VUOTOTECNICA
www.vuototecnica.net



C.so Unione Sovietica 612/3C - 10135 TORINO
Tel. 011-3913005
www.dbtec.net

Tel. 011-3273665
E-mail: info@dbtec.net

Screw driven guided linear unit
 Linearantrieb mit Rundspindel und integrierter Kugelumlaufführung
 Attuatori lineari a vite e guida a ricircolo di sfere



MTV42

TECHNICAL DATA - TECHNISCHE DATEN - - DATI TECNICI

Size - Baugröße - Taglia			42x45
Max. speed - Max. Geschwindigkeit - Velocità max			depending from the stroke
Max. stroke length - Max. Hub - Corsa max	mm		1500*
Min. stroke length - Min. Hub - Corsa min	mm		100
Pitch - Spindelsteigung - Passo vite	mm		5
Screw diameter - Spindeldurchmesser - Diametro vite	mm		12
Base weight - Gewicht bei 0mm Hub - Peso corsa 0 mm	Kg		1,8
Add for 100 mm of stroke - Achsgewicht für 100mm Hub - Peso corsa 100 mm	Kg		0,85
Max. load* - Max. Belastung - Carico max*	Fx	N	980
	Fy	N	1250
	Fz	N	1250
Moments* - Max. Belastungsmomente* - Momenti max*	Mx	Nm	22
	My	Nm	45
	Mz	Nm	45
Inertia moment Aluminum profile - Flächenträgheitsmoment - Momento d'inerzia profilo	Ix	cm ⁴	15,3
	Iy	cm ⁴	15,1
Screw tollerance class - Tolleranzklasse Kugelgewinde - Classe di tolleranza vite			T7
No load torque - Leerlaufmoment - Coppia resistente		Nm	0,15
Repeatability - Wiederholgenauigkeit - Ripetibilità		mm	±0,02

The moments and the loads above are max. values. For any further information, please contact our technical department.

Die angegebenen Momente und Belastungen sind max. Werte, die nicht überschritten werden sollen. Für weitere Informationen wenden Sie sich bitte an unser Konstruktionsbüro.

I carichi e i momenti indicati sono massimi consigliati, per ulteriori informazioni consultare il ns ufficio tecnico.

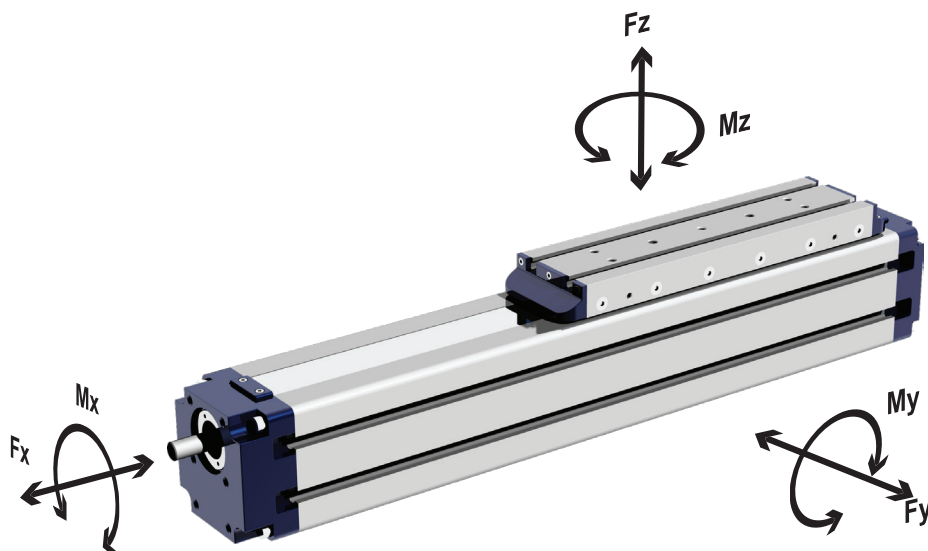

MTV42

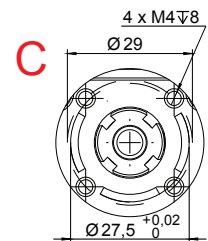
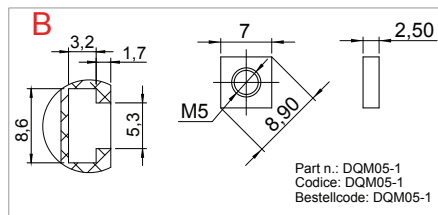
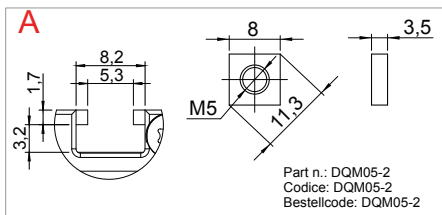
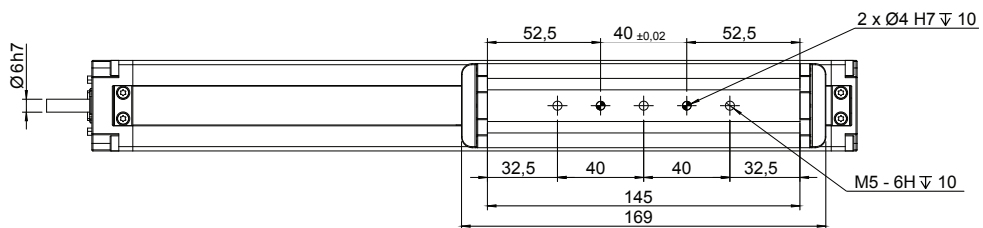
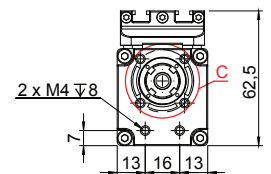
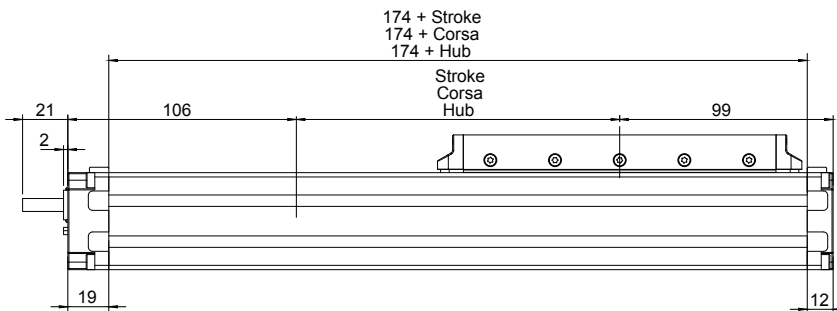
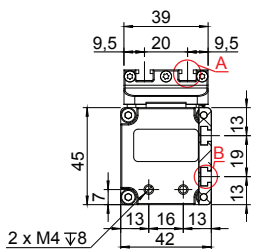
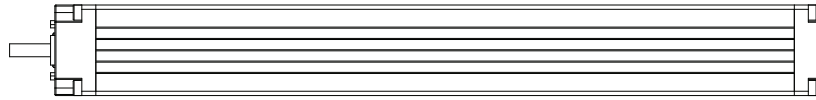

Screw driven guided linear unit
 Linearantrieb mit Rundspindel und integrierter Kugelumlaufführung
 Attuatori lineari a vite e guida a ricircolo di sfere



MTV55

TECHNICAL DATA - TECHNISCHE DATEN - - DATI TECNICI

Size - Baugröße - Taglia			55x60
Max. speed - Max. Geschwindigkeit - Velocità max			depending from the stroke
Max. stroke length - Max. Hub - Corsa max	mm		1500*
Min. stroke length - Min. Hub - Corsa min	mm		100
Pitch - Spindelsteigung - Passo vite	mm		5
Screw diameter - Spindeldurchmesser - Diametro vite	mm		16
Base weight - Gewicht bei 0mm Hub - Peso corsa 0 mm	Kg		1,8
Add for 100 mm of stroke - Achsgewicht für 100mm Hub - Peso corsa 100 mm	Kg		0,85
Max. load* - Max. Belastung - Carico max*	Fx	N	1620
	Fy	N	1850
	Fz	N	1850
Moments* - Max. Belastungsmomente* - Momenti max*	Mx	Nm	40
	My	Nm	155
	Mz	Nm	155
Inertia moment Aluminum profile - Flächenträgheitsmoment - Momento d'inerzia profilo	Ix	cm ⁴	43
	Iy	cm ⁴	48
Screw tolerance class - Tolleranzklasse Kugelgewinde - Classe di tolleranza vite			T7
Repeatability - Wiederholgenauigkeit - Ripetibilità	mm		±0,02

The moments and the loads above are max. values. For any further information, please contact our technical department.

Die angegebenen Momente und Belastungen sind max. Werte, die nicht überschritten werden sollen. Für weitere Informationen wenden Sie sich bitte an unser Konstruktionsbüro.

I carichi e i momenti indicati sono massimi consigliati, per ulteriori informazioni consultare il ns ufficio tecnico.

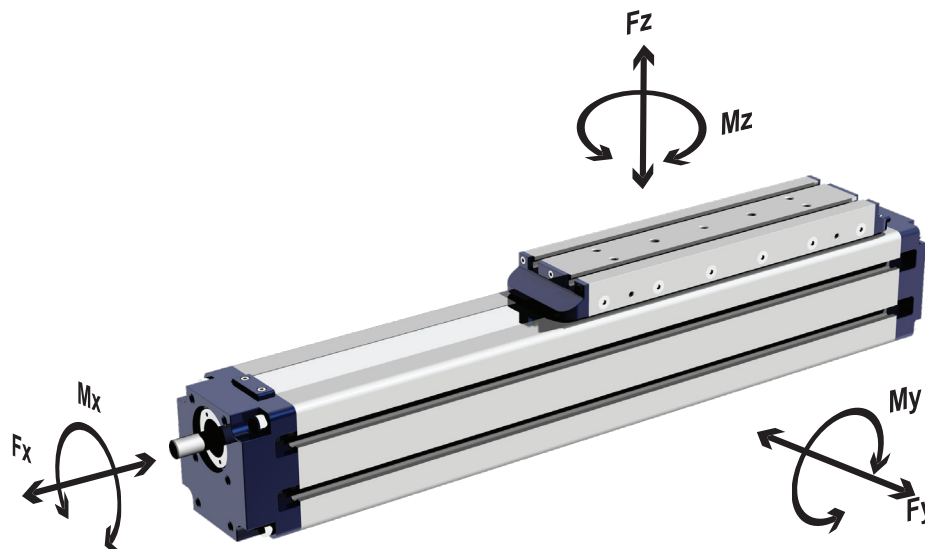

Screw driven guided linear unit
 Linearantrieb mit Rundspindel und integrierter Kugelumlaufführung
 Attuatori lineari a vite e guida a ricircolo di sfere



MTV55

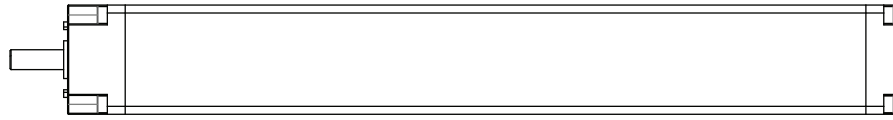

Stroke + 298
 Corsa + 298
 Hub + 298

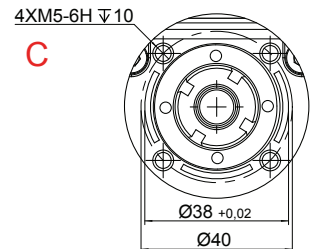
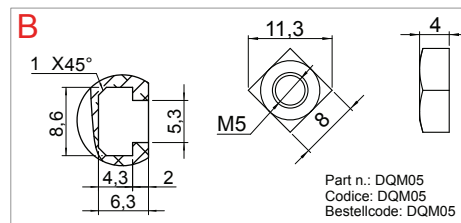
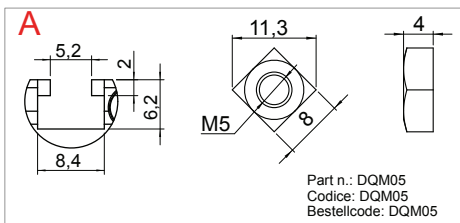
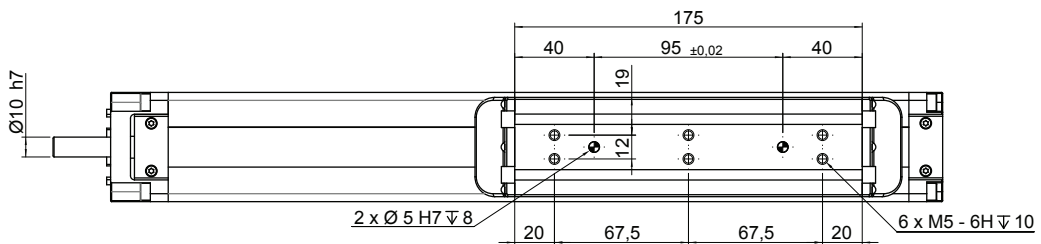
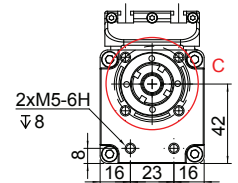
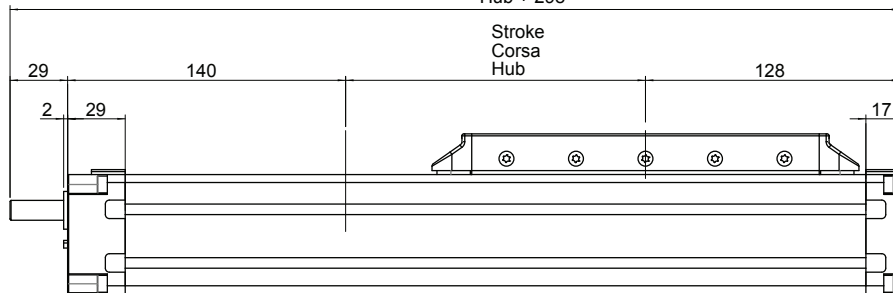
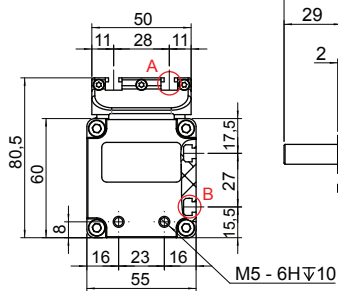

Screw driven guided linear unit
 Linearantrieb mit Rundspindel und integrierter Kugelumlauführung
 Attuatori lineari a vite e guida a ricircolo di sfere



MTV80

TECHNICAL DATA - TECHNISCHE DATEN - - DATI TECNICI

Size - Baugröße - Taglia			80x85
Max. speed - Max. Geschwindigkeit - Velocità max			depending from the stroke
Max. stroke length - Max. Hub - Corsa max	mm		1500*
Min. stroke length - Min. Hub - Corsa min	mm		100
Pitch - Spindelsteigung - Passo vite	mm		5
Screw diameter - Spindeldurchmesser - Diametro vite	mm		20
Base weight - Gewicht bei 0mm Hub - Peso corsa 0 mm	Kg		8,5
Add for 100 mm of stroke - Achsgewicht für 100mm Hub - Peso corsa 100 mm	Kg		1,2
Max. load* - Max. Belastung - Carico max*	Fx	N	3695
	Fy	N	4500
	Fz	N	4500
Moments* - Max. Belastungsmomente* - Momenti max*	Mx	Nm	90
	My	Nm	500
	Mz	Nm	500
Inertia moment Aluminum profile - Flächenträgheitsmoment - Momento d'inerzia profilo	Ix	cm ⁴	43
	Iy	cm ⁴	48
Screw tolerance class - Tolleranzklasse Kugelgewinde - Classe di tolleranza vite			T7
Repeatability - Wiederholgenauigkeit - Ripetibilità	mm		±0,02

The moments and the loads above are max. values. For any further information, please contact our technical department.

Die angegebenen Momente und Belastungen sind max. Werte, die nicht überschritten werden sollen. Für weitere Informationen wenden Sie sich bitte an unser Konstruktionsbüro.

I carichi e i momenti indicati sono massimi consigliati, per ulteriori informazioni consultare il ns ufficio tecnico.

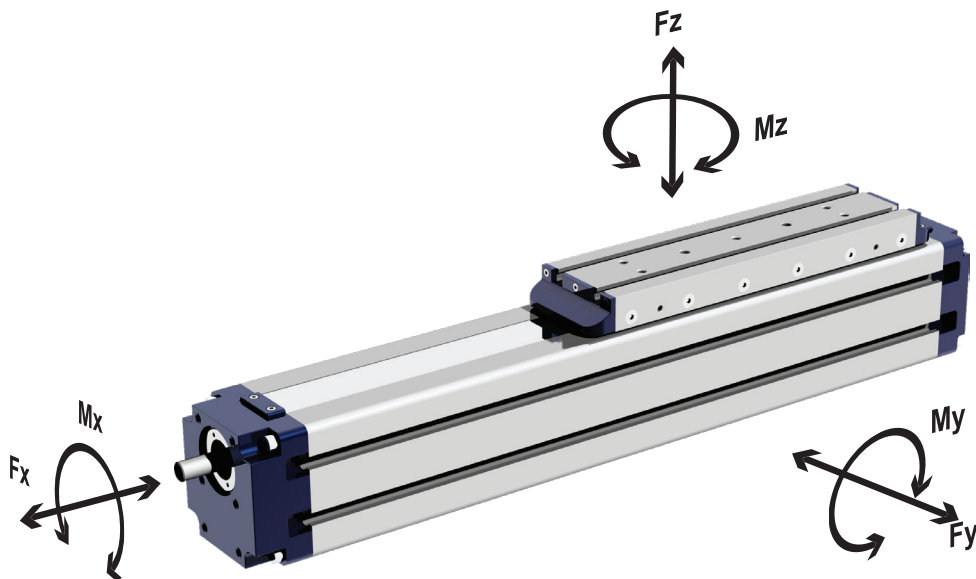

Screw driven guided linear unit
 Linearantrieb mit Rundspindel und integrierter Kugelumlaufführung
 Attuatori lineari a vite e guida a ricircolo di sfere



MTV80

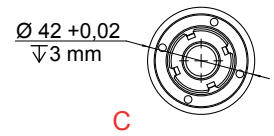
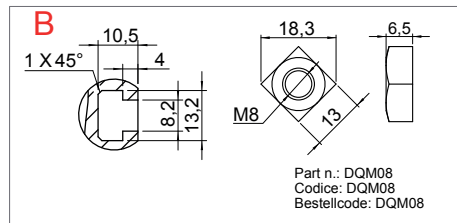
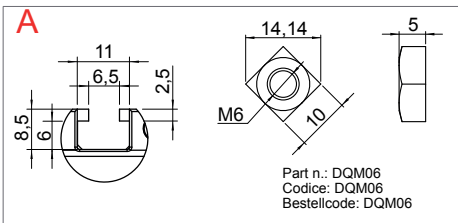
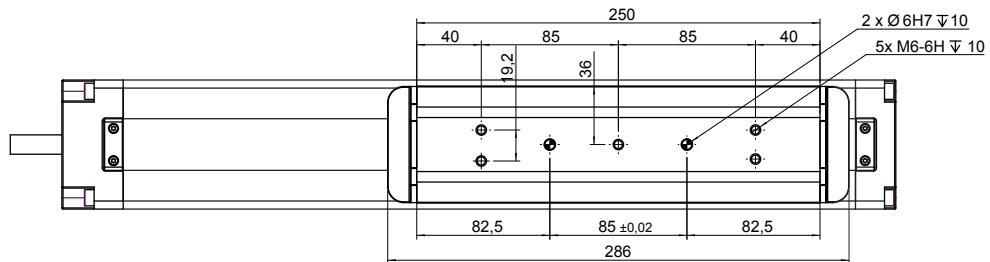
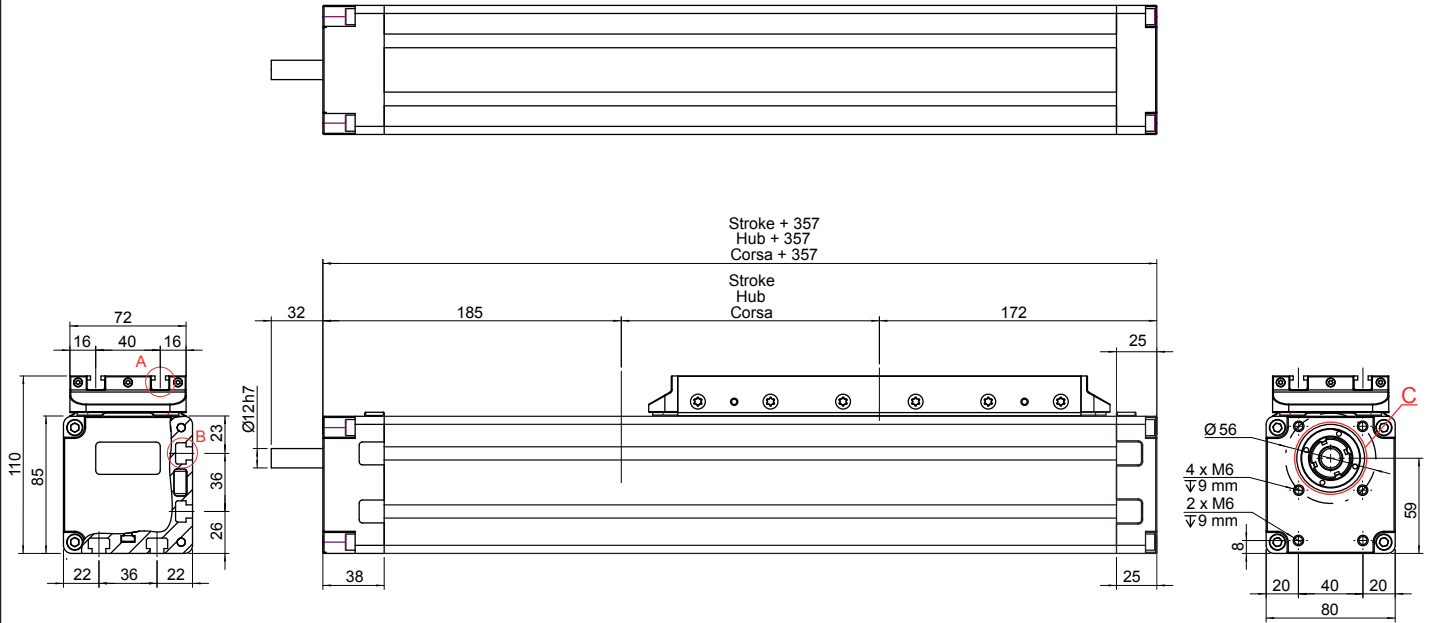

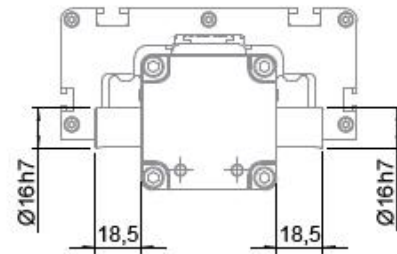
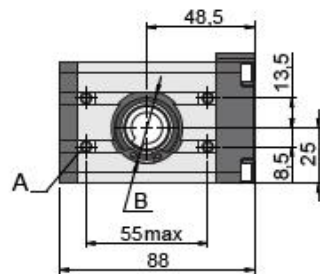
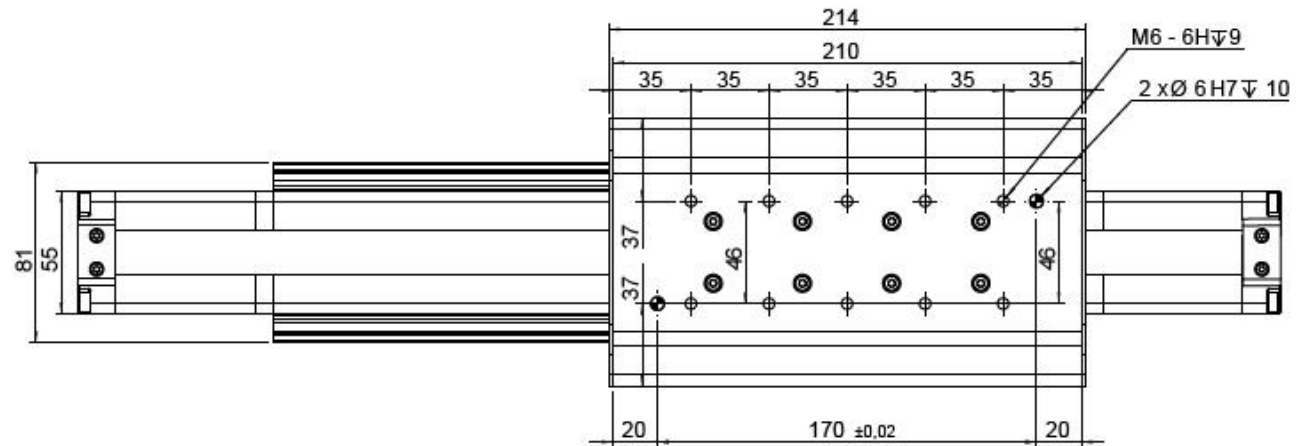
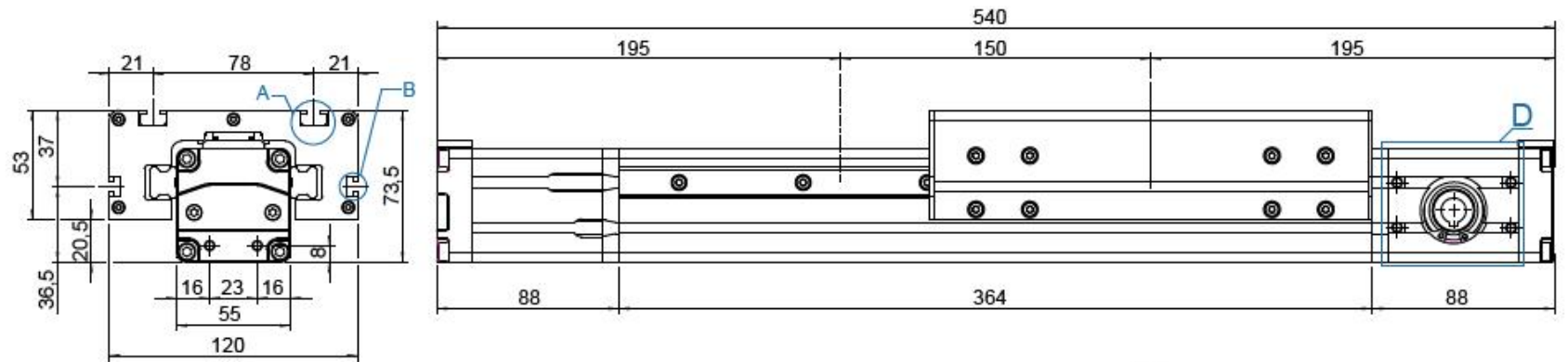

D6

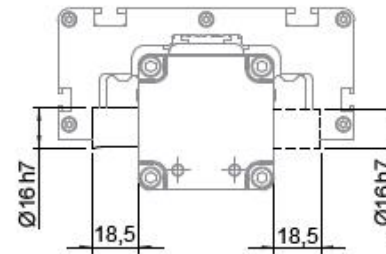

M6L-R

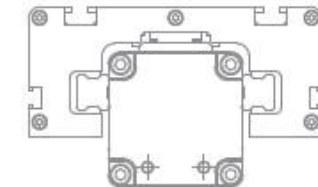

F2 - F4

A Dadi quadri M5 DIN557 già inclusi
 Square nut M5 DIN557 already included
 Vierkantmutter M5 DIN557 im Lieferumfang enthalten

B Per tutte le versioni d'albero \(\varnothing\)32 H7 prof 1,5 mm
 For all shaft version \(\varnothing\)32 H7 deep 1,5 mm
 Für alle Wellen-Versionen \(\varnothing\)32 H7 1,5 mm tief

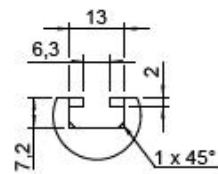

B

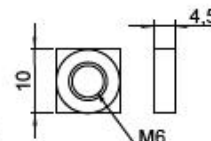

Part n.: DQM08
 Codice: DQM08
 Bestellcode: DQM08

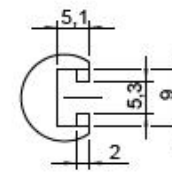

A

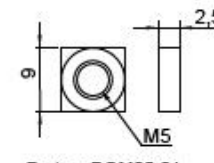

Part n.: DQM05-01
 Codice: DQM05-01
 Bestellcode: DQM05-01

213 + stroke + (2 x SPC)
 213 + hub + (2 x SPC)
 213 + corsa + (2 x SPC)

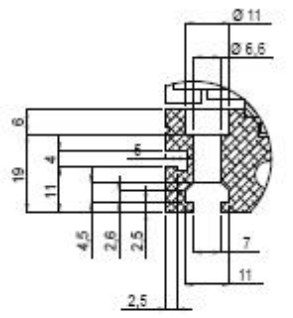
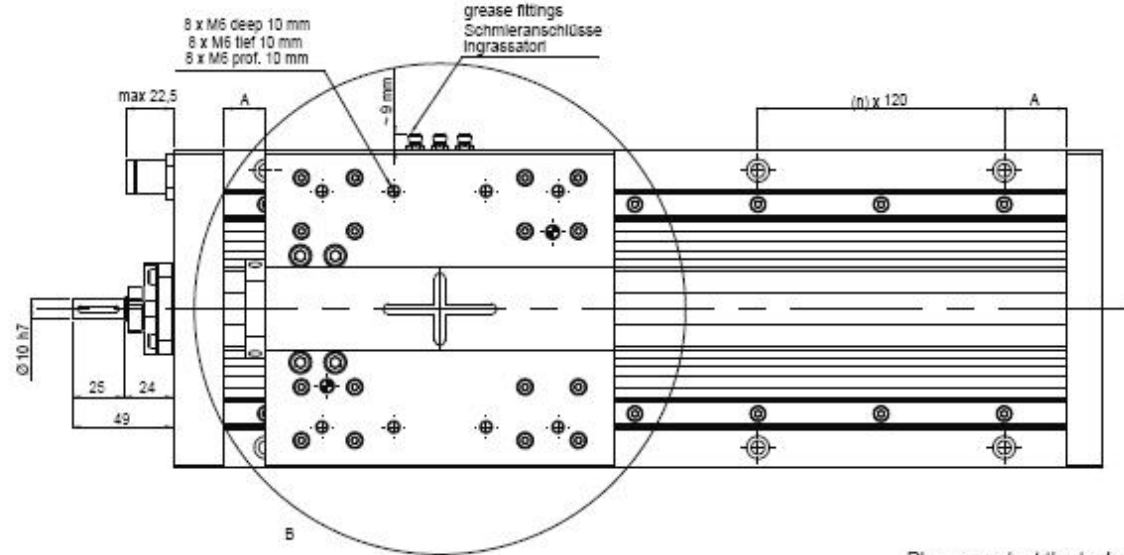
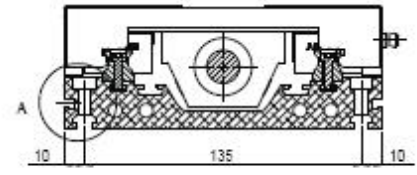
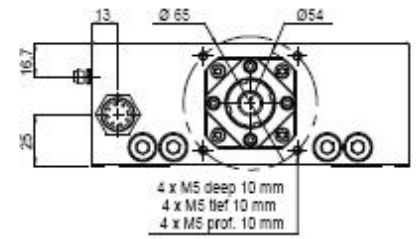
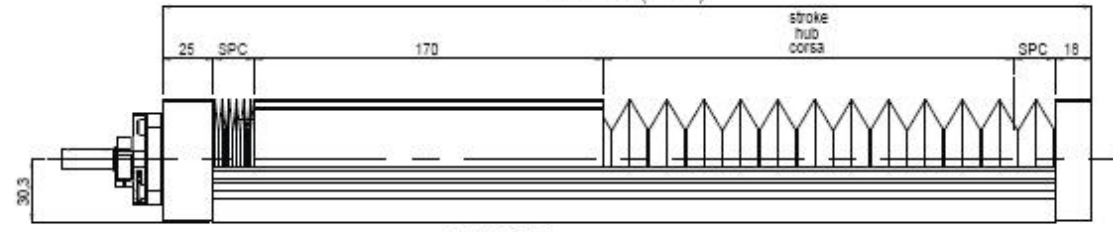
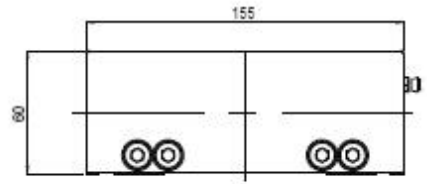

Please contact the technical department for the A and SPC dimensions

Bitte wenden Sie sich an unsere technische Abteilung

Per le quote A e SPC contattare il nostro ufficio tecnico

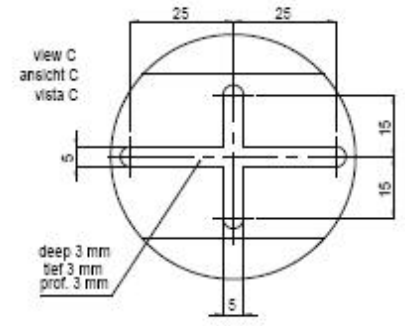
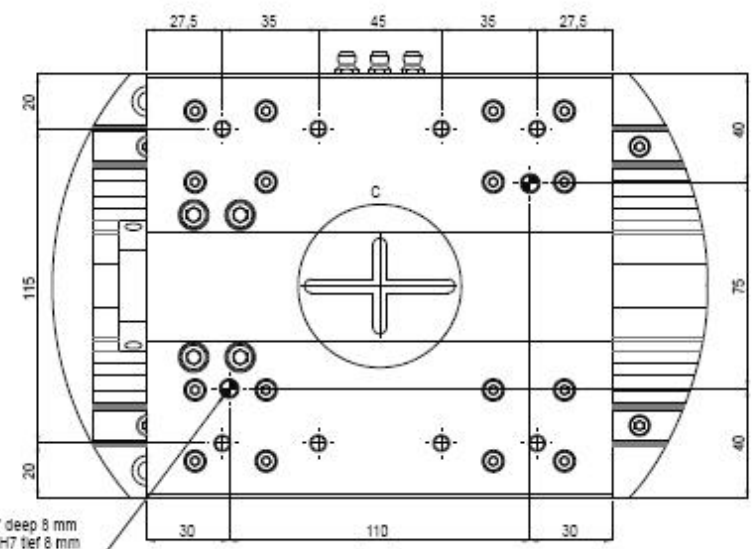

dowel pin Ø6 H7 deep 8 mm
 stiftbohrung Ø6 H7 tief 8 mm
 foro spina Ø6 H7 prof. 8 mm

view B
 ansicht B
 vista B

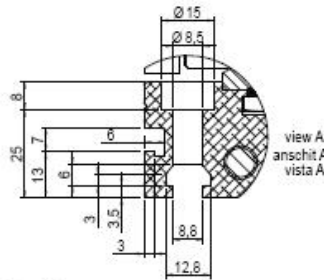
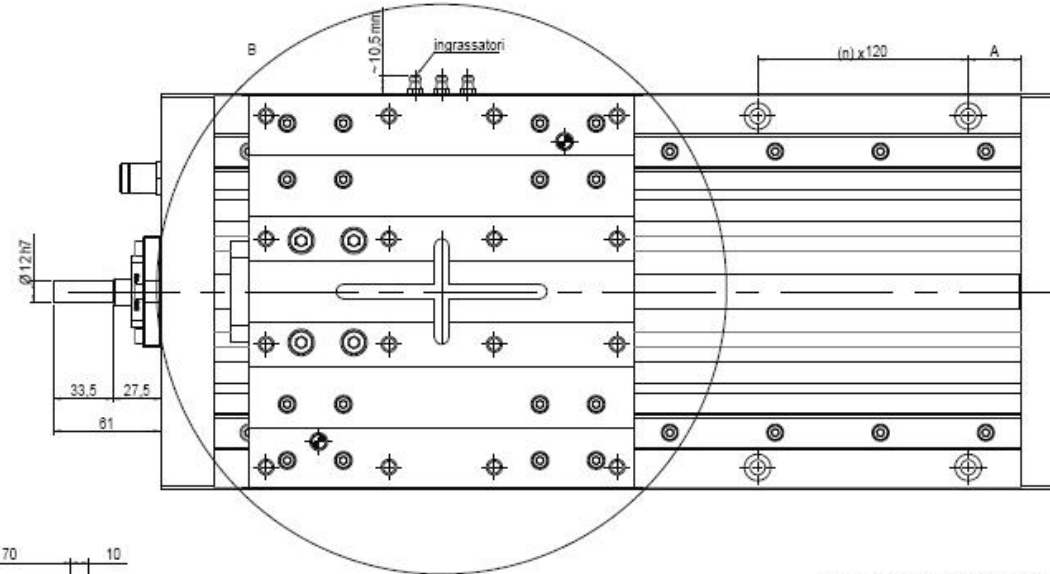
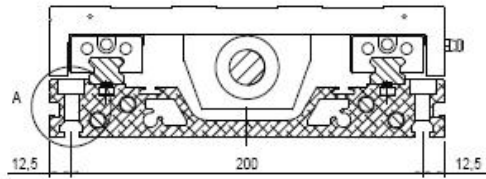
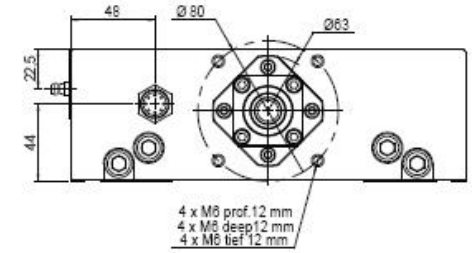
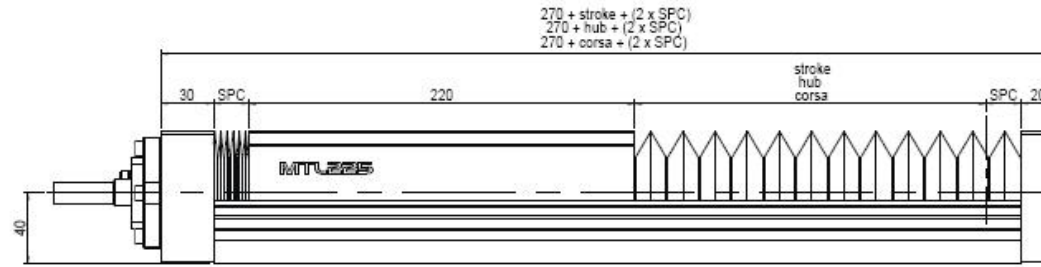
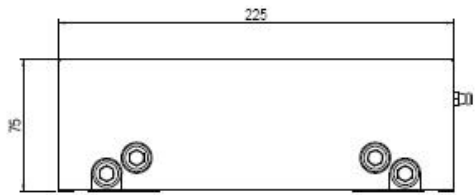

16 x M6 deep 12 mm
16 x M6 tief 12 mm
16 x M6 prof. 12 mm

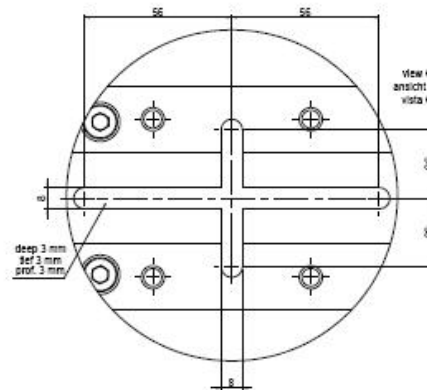
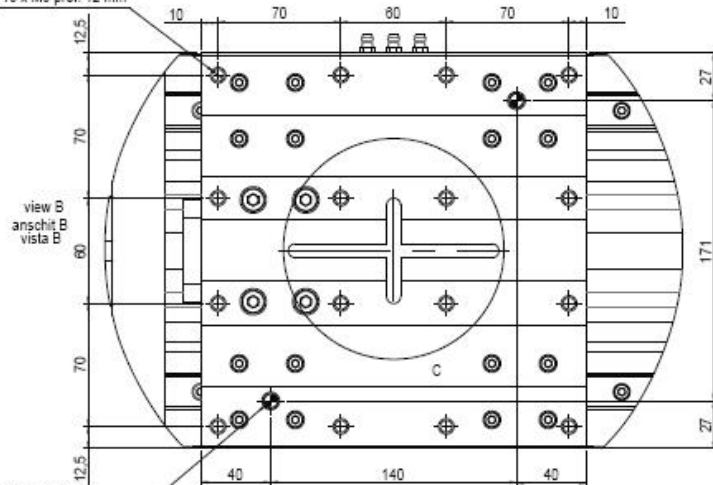

dowel pin Ø6 H7 deep 9 mm
stiftbohrung Ø6 H7 tief 9 mm
foro spina Ø6 H7 prof. 9 mm

Please contact the technical department for the A and SPC dimensions

Bitte wenden Sie sich an unsere technische Abteilung

Per le quote A e SPC contattare il nostro ufficio tecnico